

Project Name: _____ Project Location: _____ Bid Date: _____

1 Stop Logs Information

- _____ Quantity of Logs
- _____ Quantity of Frames

Log Height:

- 6"
- 12" (standard)
- 18"
- 24"

Material:

- | Logs | Frame |
|---|---|
| <input type="checkbox"/> Aluminum | <input type="checkbox"/> Aluminum |
| <input type="checkbox"/> Stainless Steel 304 | <input type="checkbox"/> Stainless Steel 304 |
| <input type="checkbox"/> Stainless Steel 316 (standard) | <input type="checkbox"/> Stainless Steel 316 (standard) |

Note: Waterman recommends stainless frame with aluminum logs.

2 Dimensions

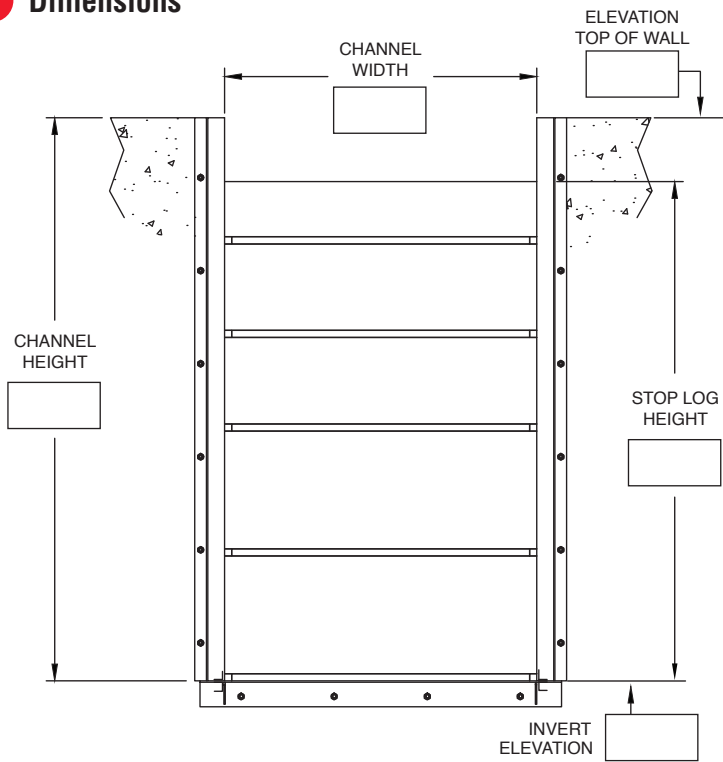

3 Mounting

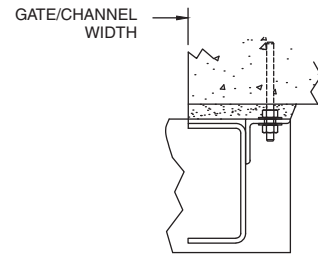

- Face Mounting End of Channel

FACE MOUNTED

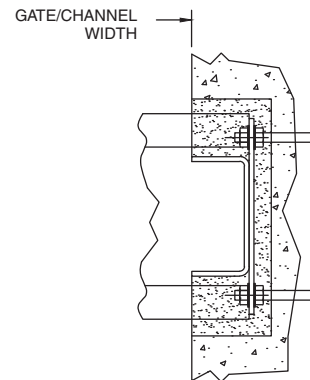

- Frame Embedded in Channel Wall

EMBEDDED CHANNEL

4 Lifting & Storage

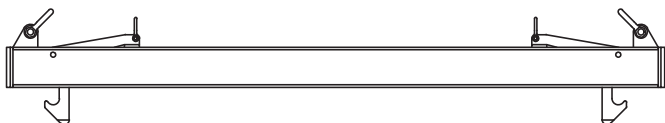

- Provide Log Lifter (standard)
- Provide floor-mount storage rack for logs not in use

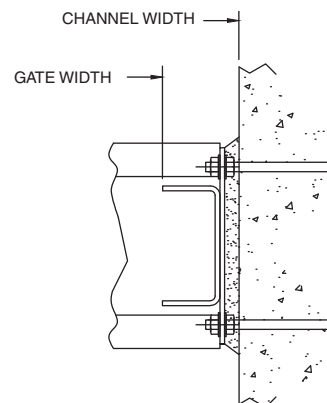

- Frame Mounted to Surface of Channel

SURFACE CHANNEL